



169 Jensen Street Whitfield, QLD

 4  3  3

Peace, privacy, outstanding convenience

This home features a flowing floor-plan inside to out, a large entertainers deck overlooking landscaped gardens and a sparkling swimming pool. The open plan living and dining area also features a relaxing reading area.

The Master Bedroom is split level to a private parlour and allows direct pool access, ensuite with corner spa and a His and Hers built in robes. There are two further generous and light filled Bedrooms with Built In's and also fully air conditioned.

NEW PRICE \$644,500

Type : House
Land : 1198 m2

David Galloway-Penney

0402483818

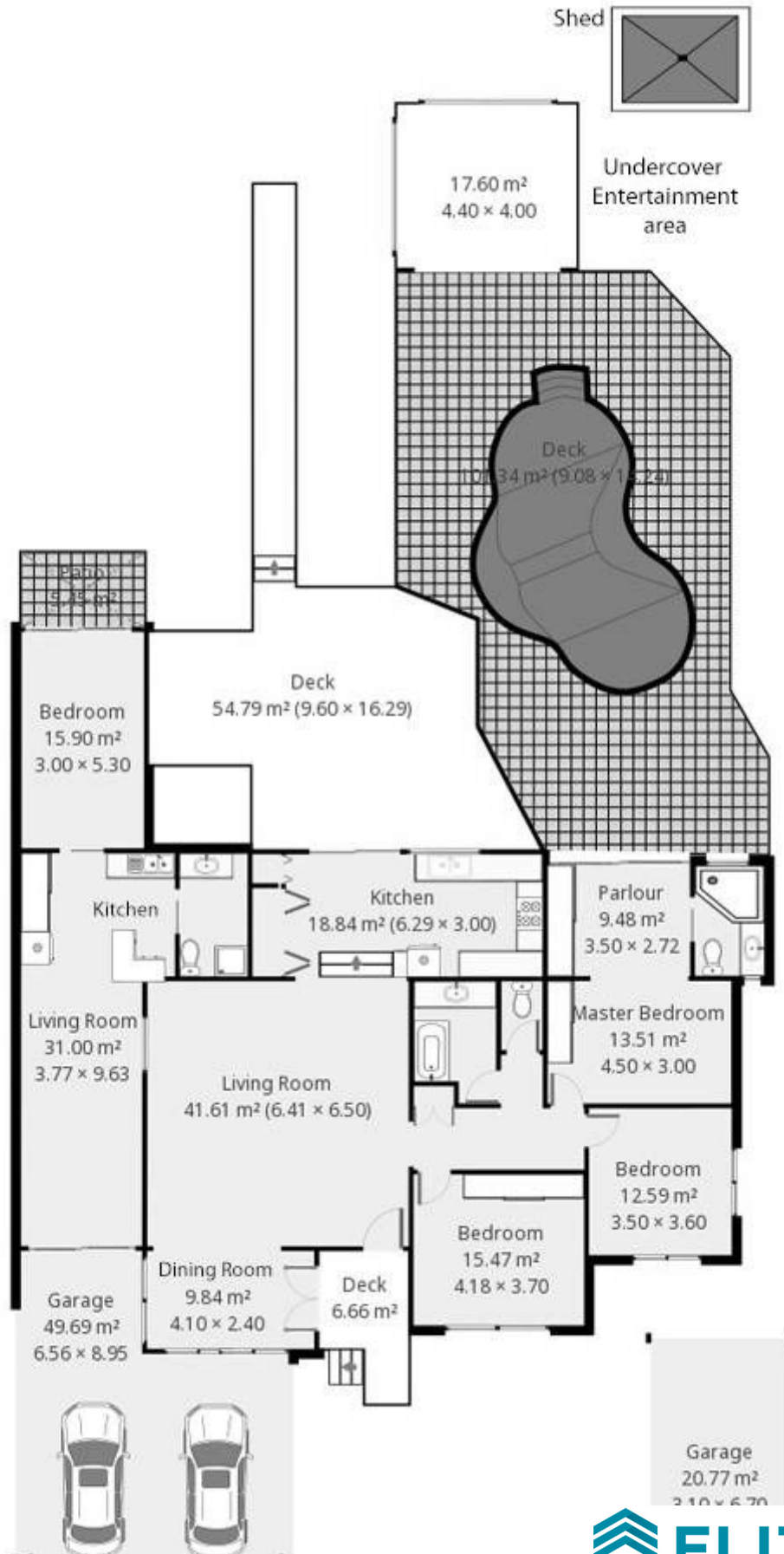

169 Jensen Street

Whitfield, QLD

